

FIRST HORIZON

GRANDE 26M

First Horizon is a brand-new Azimut Grande 26M, where cutting-edge Italian design meets effortless luxury, offering an exceptional charter experience for up to 10 guests



FIRST HORIZON - GRANDE 26M

INFORMATION

LOA
26.06 m (85' 6")

BEAM
6.30 m (20' 8")

DRAFT
2.0 m (6' 8")

BUILDER
Azimut

GUESTS
10

CREW
4

BUILT
2025

NAVAL ARCHITECT
Pierluigi Ausonio Naval
Architect & Azimut Yachts
(Hull designers) Mancini
Design (Exterior Designer)

HULL MATERIAL
GRP

HULL CONFIGURATION
Planing hull

SUPERSTRUCTURE
Hard top

CRUISING SPEED
23 kts



FIRST HORIZON - GRANDE 26M

KEY FEATURES

1

Brand-new Azimut Grande 26M
delivered in April 2026

2

Five stylish cabins with Master on Main Deck

3

Spacious Multi-Level Layout

4

Modern, Instagram Worthy Design

5

Best in Class Volume for 26m



FIRST HORIZON - GRANDE 26M

OVERVIEW

Delivered in 2026, FIRST HORIZON redefines comfort and style in the Azimut Grande 26M line. She combines sleek, modern design with spacious, multi-level living. Her deck terrace turns the cockpit into a stunning panoramic lounge, and floor-to-ceiling windows bring the beauty of the sea right into the salon. Accommodating up to 10 guests in five beautifully appointed cabins - including a full-beam master, two VIPs, one double and one twin cabin - offering comfort and sophistication at every turn. Outdoor spaces from the flybridge to the bow lounge make her perfect for both relaxation and entertaining. With cutting-edge design and a fresh 2026 delivery, FIRST HORIZON promises an unforgettable charter experience where style meets freedom.



FIRST HORIZON - GRANDE 26M

GALLERY



Bow

FIRST HORIZON - GRANDE 26M

GALLERY



Flybridge

FIRST HORIZON - GRANDE 26M

GALLERY



Aft

FIRST HORIZON - GRANDE 26M

GALLERY



Aft

FIRST HORIZON - GRANDE 26M

GALLERY



Extended aft deck

FIRST HORIZON - GRANDE 26M

GALLERY



Flybridge

FIRST HORIZON - GRANDE 26M

GALLERY



Flybridge

FIRST HORIZON - GRANDE 26M

GALLERY



Flybridge

FIRST HORIZON - GRANDE 26M

GALLERY



Flybridge

FIRST HORIZON - GRANDE 26M

GALLERY



Flybridge

FIRST HORIZON - GRANDE 26M

GALLERY



Salon

FIRST HORIZON - GRANDE 26M

GALLERY



Master cabin

FIRST HORIZON - GRANDE 26M

GALLERY



Master cabin

FIRST HORIZON - GRANDE 26M

GALLERY



Master cabin

FIRST HORIZON - GRANDE 26M

TEHNIICAL SPECIFICATIONS

LOA

26,06 m (85' 6")

BEAM

6,30 m (20' 8")

DRAFT

2,0 m (6' 8")

GUESTS

10

CABINS

5

CABIN CONFIGURATION

4 Double Cabins,
1 Single Cabins

BED CONFIGURATION

1 King Beds, 2 Queen Beds,
1 Double Beds, 2 Single Beds

ENGINES

MAN V12 Diesel engines
Max. Power 2x1213 kW
(1550 HP) Eco Cruising
Speed 20 kn Fuel

CONSUMPTION

600 l/h (at Max speed)
464 l/h
(at cruising speed @ 20 knts)
395 l/h (at eco speed)

FUEL CONSUMPTION

464 Litres/Hr (cruising),
600 Litres/Hr (max),
395 Litres/Hr (eco)

CRUISING SPEED

23 kts

MAX SPEED

26 kts

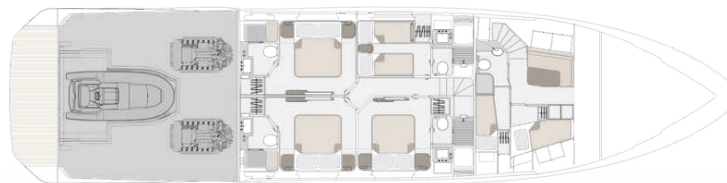
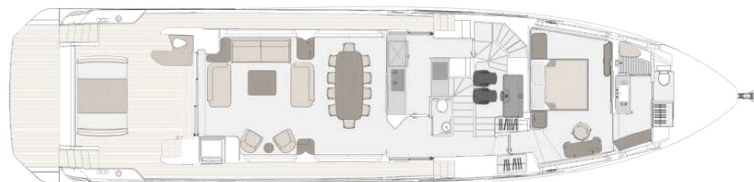
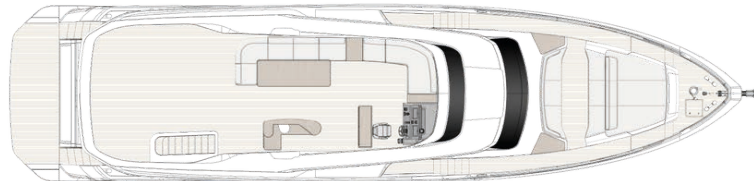

FIRST HORIZON - GRANDE 26M

TENDER & SEA TOYS / EQUIPMENT

> Tender Williams Jet 385

> Jet ski

> Seabob

> Water ski

> Doughnut

> SUP

> Jet surf

Snorkeling Equipment

> Air conditioning

> Stabilisers at anchor

> Stabilisers underway



FIRST HORIZON

GRANDE 26M



We invite you to
discover fascinating
Croatia with us!