

KIMANI

BLUEGAME BG74

The KIMANI is
a yacht like no
other, combining
innovative design
with ultimate comfort
for an unforgettable
experience



KIMANI ~ BLUEGAME BG74

INFORMATION

LOA

22.82 m (74' 10")

BEAM

5.60 m (18' 4")

DRAFT

1.6 m (5' 3")

GUESTS

6

CREW

2

CABINS

3

BUILT

2025

BUILDER

Sanlorenzo SpA (Italy)

NAVAL ARCHITECT

Luca Santella & Zuccon
International Project

HULL MATERIAL

GRP

SUPERSTRUCTURE

Open

HULL CONFIGURATION

Planing hull



KEY FEATURES

1

The brand-new Bluegame yacht

2

These are the sample photos

3

KIMANI offers simplicity, easy maneuverability, comfort, and safety during navigation

4

She features a cockpit with 360° visibility, a first-of-its-kind innovation for an open yacht

5

The yacht offers expansive outdoor spaces, including a beach area, spacious living/ dining area, adaptable bow, and easily accessible sundeck

6

Equipped with stabilizers for both underway and at-anchor stability



"KIMANI" is a revolutionary yacht that blends the BG range's open layout with the BGX series flybridge concept, creating a truly unique design.

Expertly crafted by Luca Santella, she features a high-performance hull designed by Lou Codega and is powered by a Volvo IPS propulsion system, ensuring superior performance and fuel efficiency.

The yacht's cockpit offers an impressive 360° visibility, complemented by an inverted windscreen and the option for full closure, providing privacy or protection.

With interior and exterior spaces designed by Zuccon International Project, "KIMANI" is both stylish and functional.

She boasts expansive outdoor areas across three levels, featuring a beach area, a spacious living/dining space, a versatile bow, and an easily accessible sundeck, providing guests with multiple luxurious spots to fully enjoy the sea.

Inside, she offers 3 elegant en-suite cabins accommodating up to 6 guests, with a professional crew of 2 dedicated to delivering an exceptional, personalized experience throughout the journey.



KIMANI ~ BLUEGAME BG74

GALLERY



Galley

KIMANI ~ BLUEGAME BG74

GALLERY



Master cabin

KIMANI ~ BLUEGAME BG74

GALLERY



Twin cabin

KIMANI ~ BLUEGAME BG74

GALLERY



Bathroom

KIMANI ~ BLUEGAME BG74

TEHNICAL SPECIFICATIONS

LOA

22.82 m (74' 10")

BEAM

5.60 m (18' 4")

DRAFT

1.6 m (5' 3")

GUESTS

6

CABINS

3

CABIN CONFIGURATION

1 double, 2 twin
(can be converted)

BED CONFIGURATION

1 King, 4 single or 3 king
(as 4 single beds can
be converted into
2 double beds)

ENGINES

2 X VOLVO PENTA IPS
1350 D13 / 2 X 735 KW /
1000 HP STD

GENERATORS

Kohler

FUEL CONSUMPTION

220 Litres/Hr (cruising),
380 Litres/Hr (max),
130 Litres/Hr (eco)

CRUISING SPEED

24 kts

MAX SPEED

30 kts

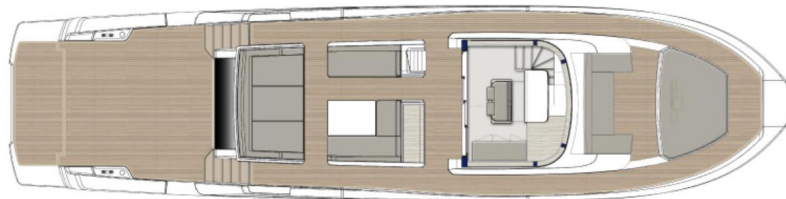

KIMANI ~ BLUEGAME BG74

TENDER & SEA TOYS / EQUIPMENT

> AGILIS Jet Tender 305C,
for 4 persons, 90 HP/top speed 37 knots

Jet ski RXP-X* RS 325

Snorkeling gear

> Air conditioning

> Stabilisers at anchor

> Stabilisers underway

> WiFi connection



KIMANI

BLUEGAME BG74

We invite you
to discover
fascinating
Croatia with us!

