

DREAM
CYRUS 33

Dream, a luxurious
Cyrus Yacht, features a
stunning flybridge with a
jacuzzi, bar and a perfect
space for alfresco dining,
offering both comfort
and elegance



DREAM - CYRUS 33

INFORMATION

LOA

33.30 m (109' 3")

BEAM

7.10 m (23' 4")

DRAFT

1.4 m (4' 7")

NAVAL ARCHITECT

Rene Van Der Velden

BUILT

2007

REFIT

2023

GUESTS

10

CREW

6

YACHT TYPE

Motor-sailer

HULL MATERIAL

GRP

HULL CONFIGURATION

Planing hull

SUPERSTRUCTURE

Flybridge



DREAM - CYRUS 33

KEY FEATURES

1

At-Ancor and Underway Stabilizers

2

Mint conditions

3

Spacious flybridge with a Jacuzzi

4

Full-beam Master cabin for superior comfort

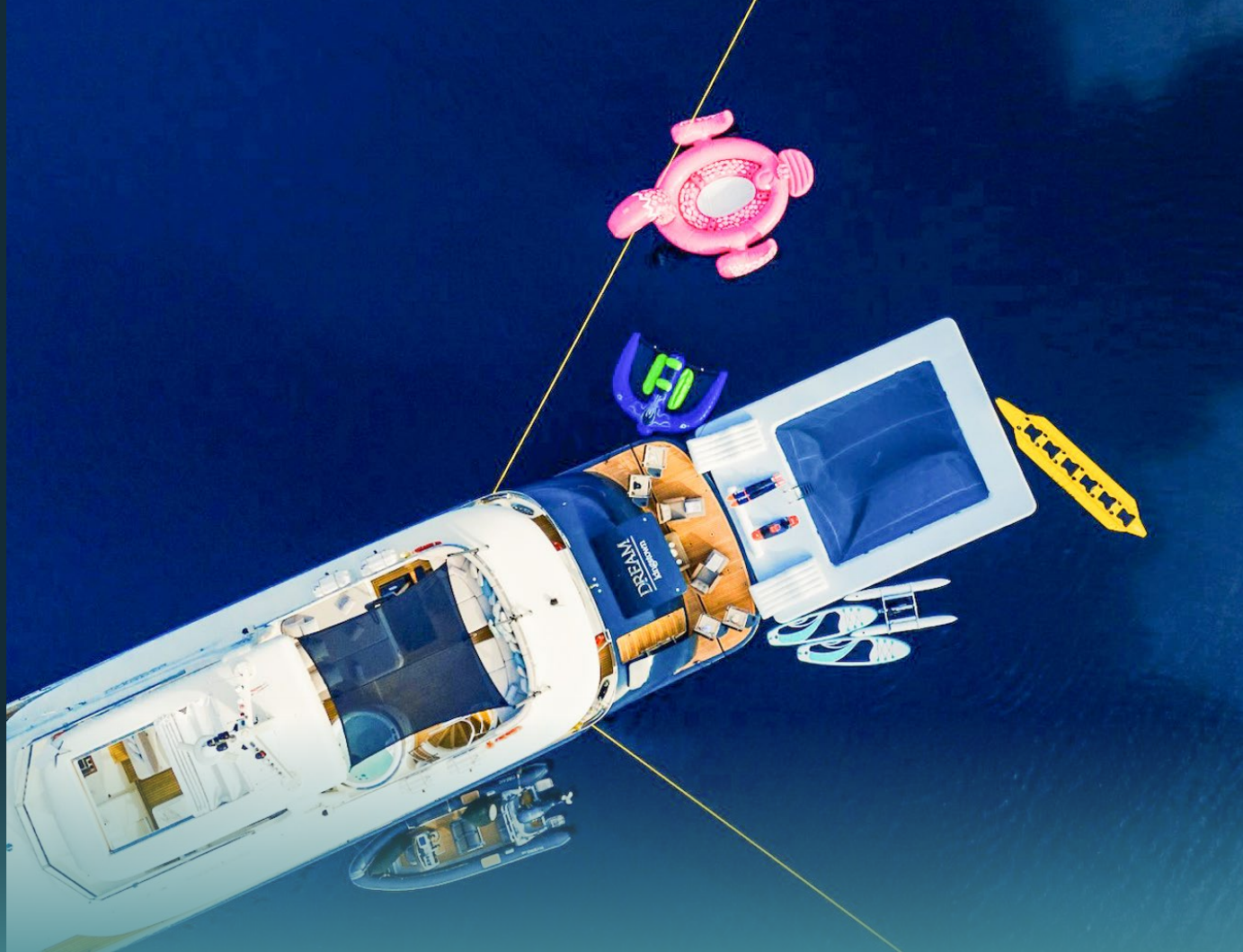

DREAM - CYRUS 33

OVERVIEW

DREAM is a stunning yacht that impresses with her elegance and comfort. Built by Cyrus Yachts, she has undergone a refit in 2023, ensuring she's in pristine condition for her guests. Stretching 33.96 meters, this yacht offers smooth cruising at 14 knots, with a top speed of 24 knots. Moreover, equipped with stabilizers both underway and at anchor, DREAM provides a stable and relaxing journey.



DREAM - CYRUS 33

GALLERY

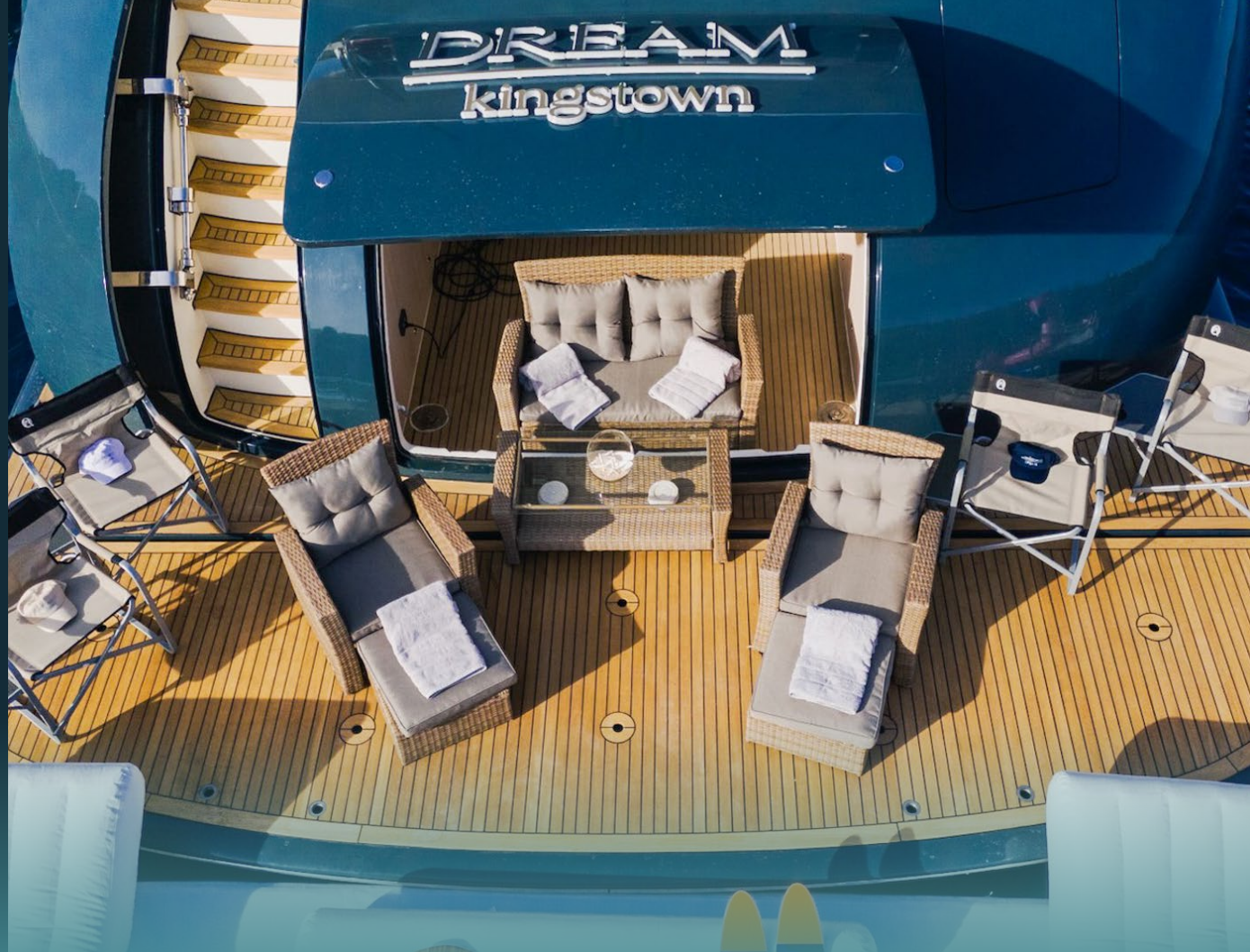

Beach club

DREAM - CYRUS 33

GALLERY



Al fresco table

DREAM - CYRUS 33

GALLERY



Aft side view

DREAM - CYRUS 33

GALLERY

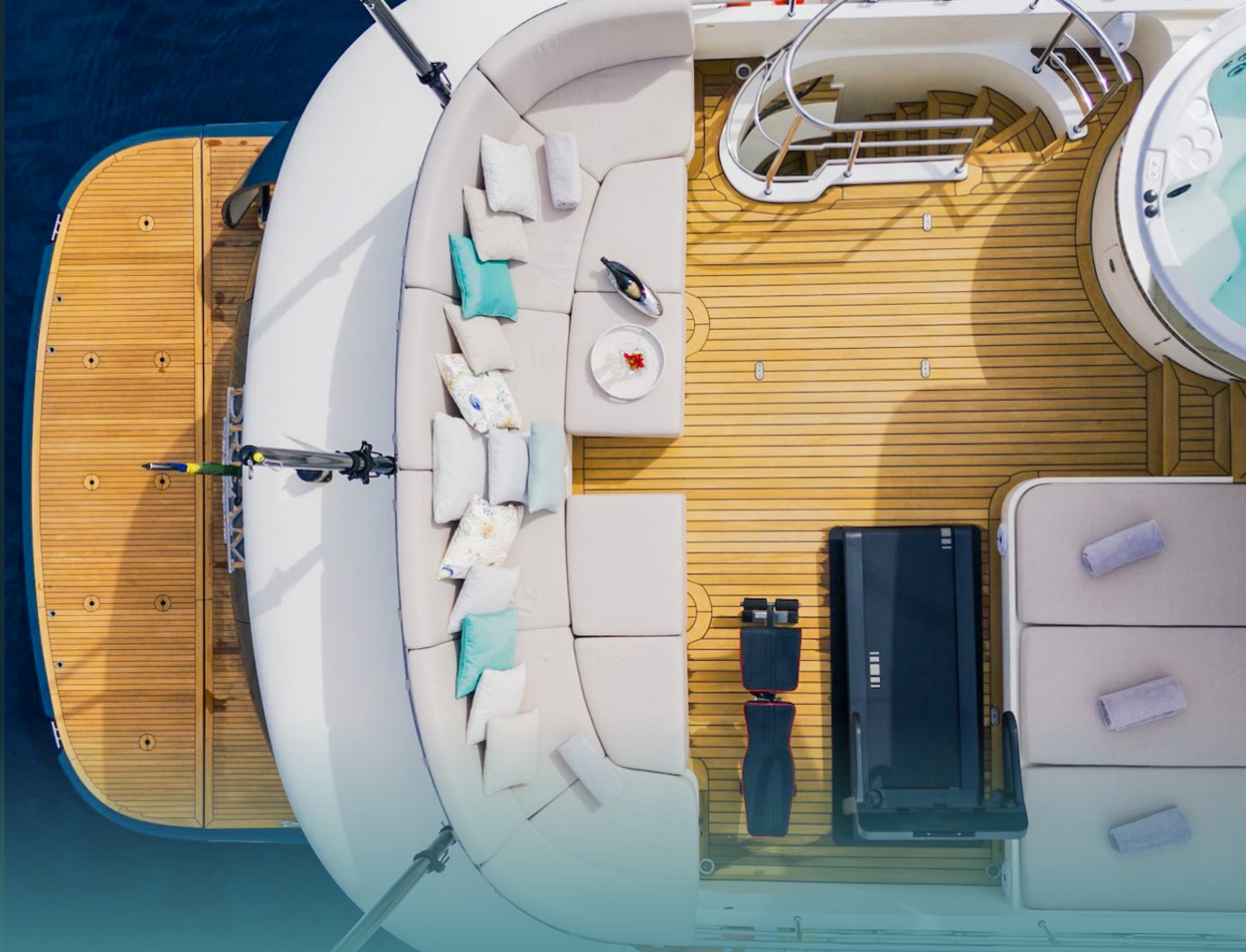

Flybridge aerial

DREAM - CYRUS 33

GALLERY



Jacuzzi

DREAM - CYRUS 33

GALLERY



Flybridge

DREAM - CYRUS 33

GALLERY



Flybridge table and lounge

DREAM - CYRUS 33

GALLERY

Exercise equipment



DREAM - CYRUS 33

GALLERY



Salon

DREAM - CYRUS 33

GALLERY



Salon facing aft

DREAM - CYRUS 33

GALLERY



Salon at night

DREAM - CYRUS 33

GALLERY



Master cabin

DREAM - CYRUS 33

GALLERY



Master cabin view

DREAM - CYRUS 33

GALLERY



Master cabin bathroom

DREAM - CYRUS 33

GALLERY



Double cabin

DREAM - CYRUS 33

GALLERY



Cosmetic table

DREAM - CYRUS 33

GALLERY

Double cabin bathroom



DREAM - CYRUS 33

TEHNIICAL SPECIFICATIONS

LOA

33.30 m (109' 3")

BEAM

7.10 m (23' 4")

DRAFT

1.4 m (4' 7")

GUESTS

10

CABINS

5

HOMEPORT

Šibenik (Croatia)

CABIN CONFIGURATION

3 Double Cabins,
2 Twin Cabins

BED CONFIGURATION

3 King Beds,
4 Single Beds

ENGINES

2 x Caterpillar C32 V12 1675 HP
2 x 40 kW ONAN

FUEL CONSUMPTION

225 Litres/Hr (cruising)

CRUISING SPEED

14 kts

MAX SPEED

24 kts

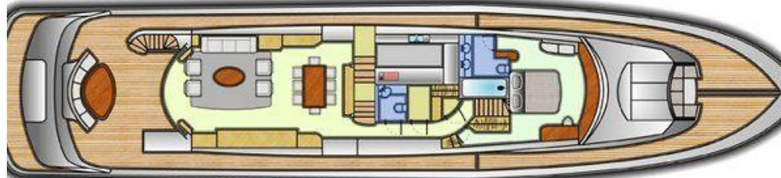
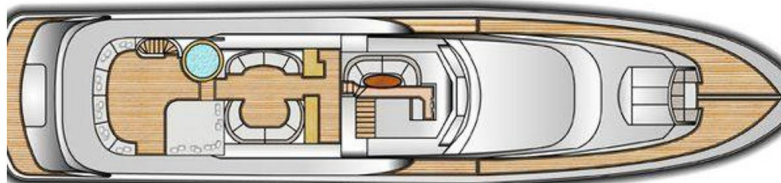

DREAM - CYRUS 33

TENDER & SEA TOYS / EQUIPMENT

- > 6 M Ribeye RIB with custom seating, fully rebuilt in 2023
 - > 2 x Water Bike
 - > Water Ski
 - > Wakeboard
 - > Banana
 - > Floating Toys
 - > 2 x SUP
 - > Inflatable Flamingo
 - > Jet Ski available on request
- > Air conditioning
- > Stabilisers underway
- > Stabilisers at anchor
 - > Deck Jacuzzi
 - > WiFi connection



DREAM
CYRUS 33

We invite you to
discover fascinating
Croatia with us!

