

DIAMOND

Liva



INTRODUCING 'DIAMOND DIVA'

DIAMOND DIVA seamlessly combines cutting-edge design, generous living spaces, and impressive sailing capabilities. Just like a floating villa on the sea.

DESIGN

A defining feature of DIAMOND DIVA is its expansive aft cockpit, which opens directly to the sea. Equipped with fold-down terraces, this space offers effortless access to the water, enhancing the connection between the catamaran and its surroundings. Wide, gently sloping steps ensure safe and comfortable entry.

The design allows a fluid transition between indoor and outdoor areas, creating a cohesive and inviting onboard atmosphere. The high-quality materials and finishes provide a modern and refined feel.

Perfect for up to 8 guests in 4 cabins, each with its own en-suite bathroom, offering privacy and comfort.

LOCATION

This breathtaking new model is based in Split, Croatia. Your itinerary can be personalised and may include local Hvar, Brač, Korčula and Vis islands.

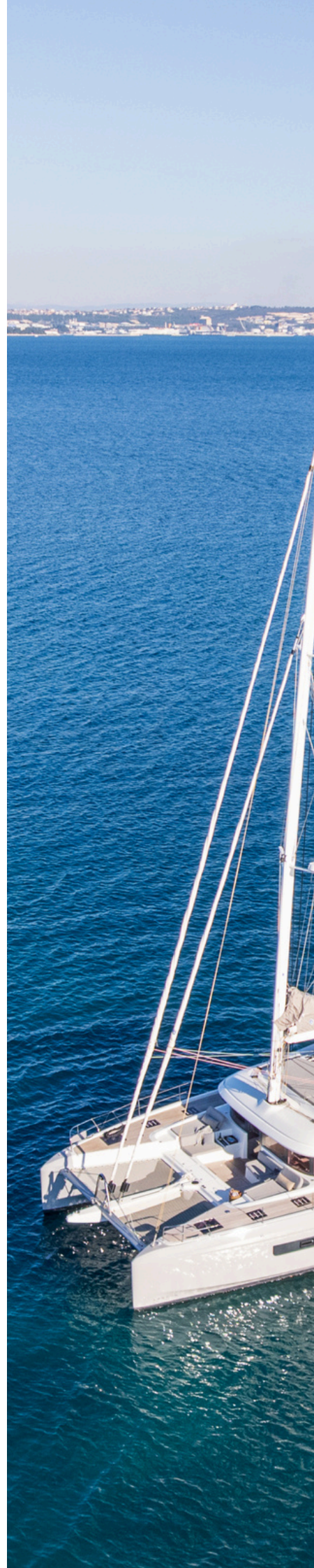

CREW

Our professional captain and hostess allow guests to fully relax while everything is taken care of, from navigating to preparing meals. Our crew are professional and well regarded. They will do their utmost for your ultimate vacation and VIP experience. Prior to boarding, our crew will stock the catamaran with your favorite food and beverages.

INTERIOR

Spacious and elegantly designed, the cabins provide comfort and privacy, each featuring an en-suite bathroom. The master suite serves as a refined sanctuary, complete with ample storage and expansive windows that flood the space with natural light.

EXTERIOR

A vast flybridge offers panoramic 360-degree views and a luxurious lounging area, perfect for sunbathing or sunset cocktails.

Conveniently accessible from the saloon, the forward cockpit provides a serene and comfortable retreat, enhancing the catamaran's open-air living experience.

The stern features a versatile hydraulic platform that functions as both a tender lift and an extended beach area, further strengthening the seamless connection to the sea.

With its innovative design and exceptional features, DIAMOND DIVA is the ultimate choice for those seeking a luxury sailing experience.





The flybridge provides breathtaking panoramic views and features a spacious 27-square-meter layout with two distinct living areas. Ample space allows for easy movement and socialising, enhancing the experience of sailing and anchoring. The forward relaxation area features expansive sun loungers, ideal for unwinding and taking in the scenery.

A large folding table accommodates up to 10 guests, while the stylish bar includes a fridge, ice maker, storage and sink. The helm station is designed for effortless navigation, with winches conveniently within reach.

AFT COCKPIT



Each living space is thoughtfully designed for seamless movement on board, with wide direct access to the cockpit and flybridge.

The spacious cockpit spans 36 square meters, expanding even further with the side platforms deployed. DIAMOND DIVA also boosts a magnificent terrace right on the water with the extended hydraulic platform.

A large folding table seats up to 12 guests, complemented by a generous sunbathing area. The table can be split into 2 smaller ones, providing more space when not used for dining. Additional amenities include ample storage, an integrated fridge, sink, and pop-up lamp. The integrated grill is another wonderful feature.



SALOON



The DIAMOND DIVA salon connects seamlessly with the cockpits. The luxurious area boasts 40 square meters of lounge, dining and bar space with panoramic views. This 4-cabin version has an additional navigation area and a bar that compliments the galley below.

The modern L-shaped lounge offers comfort and style, complete with a coffee table and concealed TV. The bar features a fridge, sink, fridge, wine storage and ice maker.



FORWARD COCKPIT

The ideal space to unwind and take in the scenery.

Each living space is thoughtfully designed for seamless movement on board. The front cockpit is designed for both comfort and relaxation, offering generous seating and sun loungers with adjustable headrests for added luxury.



LAYOUT

DIAMOND DIVA is suitable for up to 8 guests in 4 guest cabins, and an additional 2 crew members (with separate crew sleeping areas on the Forward AFT).

The cabins are luxurious with ample storage and private bathrooms. The large windows in each cabin make it feel open and connected to the sea. Each room has air-conditioning, heating and power outlets.

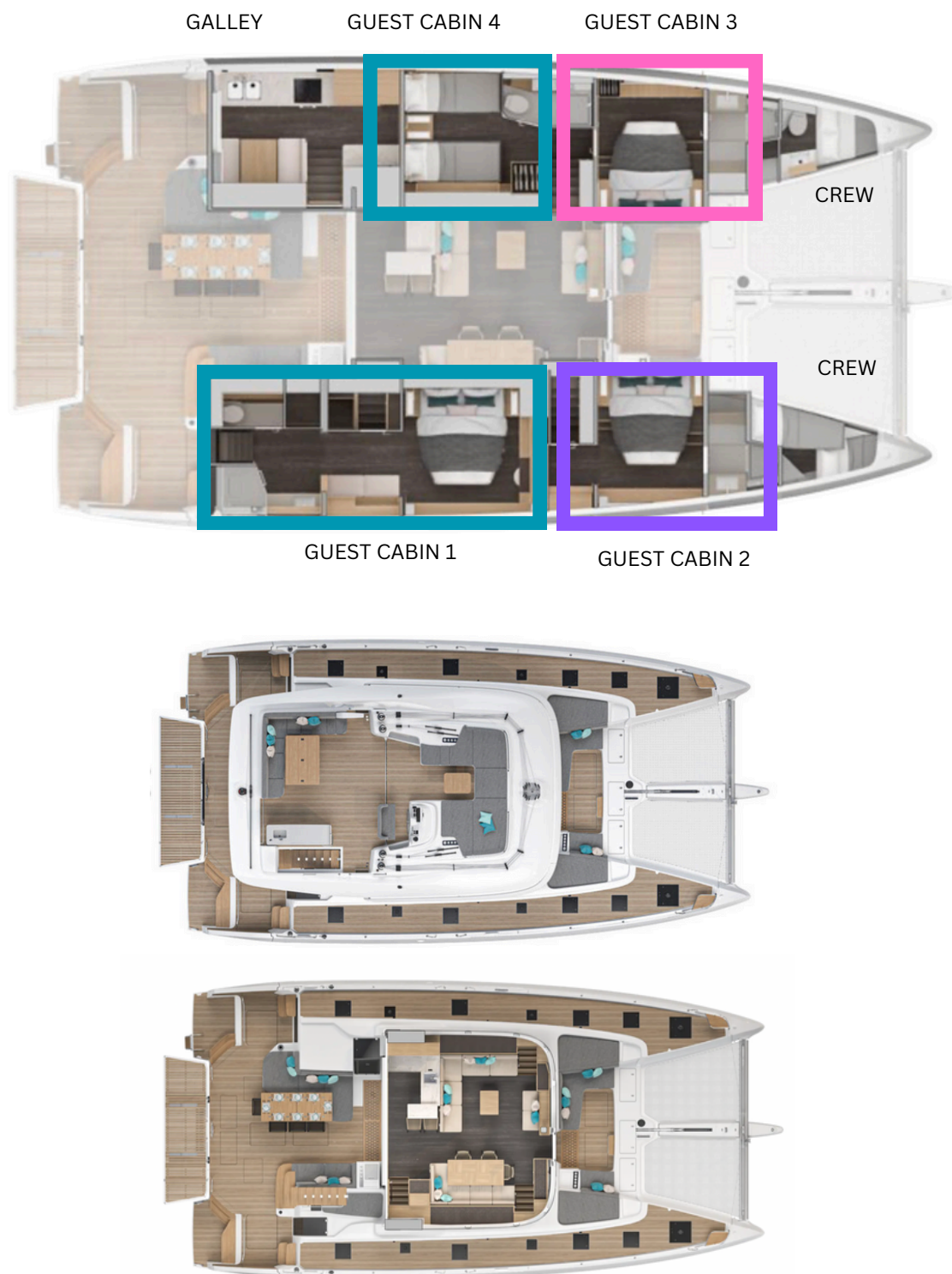

GUEST CABIN 1



DIAMOND DIVA'S main guest cabin provides a serene atmosphere. The 'owner's cabin' is divided into three sections and is generous in space.

The bathroom has direct access to the cockpit. It has beautiful corian stone finish, a large shower and separate toilet.

A sliding door offers privacy from the sleeping area.

The mid-section has access from the saloon with beautiful storage spaces.



CABIN 2



A beautifully designed cabin offering breathtaking views and generous storage space, complemented by a separate bathroom.

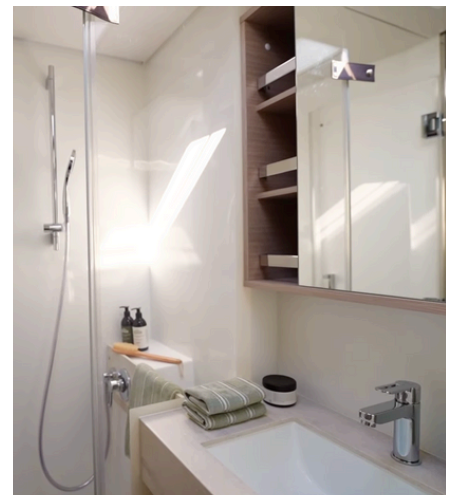

CABIN 3



This luxurious cabin boasts premium finishes, a raised bed, ample storage and stunning views. It also includes a private bathroom with a shower, toilet and basin.



CABIN 4

Designed for comfort and versatility, this cabin features two sliding beds that can easily convert into a double bed, providing flexible sleeping arrangements.

Integrated storage and fabric wall panels add to the cabin's functionality and aesthetic. The private bathroom includes a toilet, sink and shower for added convenience.



GALLEY

Located below deck, the galley is a fully equipped private space. It includes a 600L fridge, cooktop, oven, dishwasher, microwave, washing machine and abundant storage.

The private dining area for the crew provides privacy for the guests.

Prior to your arrival, our hostess will be in contact with you and stock all your favorite food and drinks onboard.



WHAT'S ONBOARD?

EQUIPMENT

Generator. Watermaker. Dinghy with motor. Classic mainsail. Inverter. Hydraulic lift. Ice maker. Clothes washing machine. Air-conditioning and heating in galley and all cabins. Power points throughout. Towels. Bed Linen. Pillows. Wine fridge. Teak.

KITCHEN

Fully equipped kitchen . Dishwasher. Dual sink. Stone bench top. Microwave. Cooktop and oven. Plenty of storage. Built-in bar area. Refrigeration and freezer. Kitchen plates, glasses, pots and utensils. Coffee machine.

NAVIGATION

Autopilot. GPS plotter.

ENTERTAINMENT

Wi-fi. Bluetooth.TV. Stand-up paddles. Sea scooters. Snorkelling sets. Audio system.

E-foil and seadoo's available by request (additional extra).

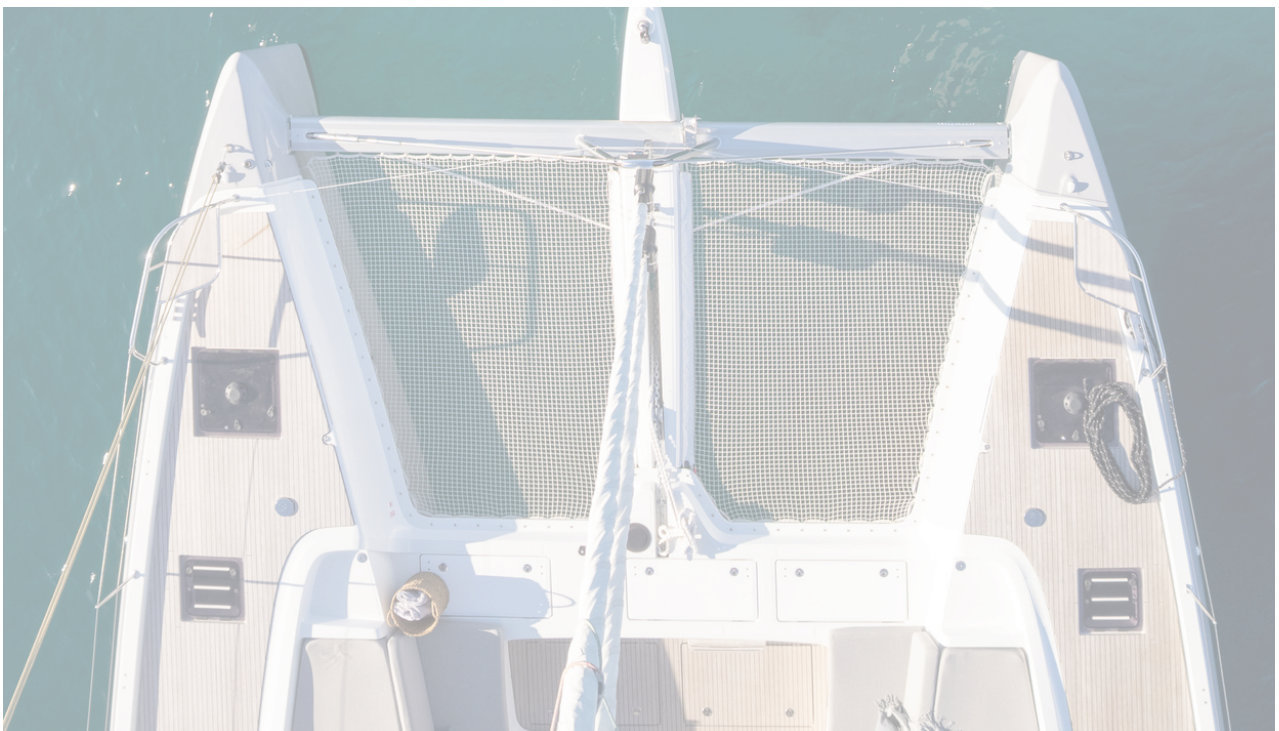



DISCLAIMER All specifications are given in good faith and offered for informational purposes only. Catamaran inventory, specifications and charter prices are subject to change without prior notice.