



NAVILUX



NAVILUX

2

LOA **37.30 m (122' 5")** Beam **8.30 m (27' 3")** Draft **3.2 m (10' 6")** Built **2012**
Builder/Designer **Gulet** Guests **12** Cabins **6** Crew **8** Speed **12.5 knots**

KEY FEATURES

1

Accommodation for up to 12 guests in **6 fairly equal staterooms**

2

Vast salon with **spacious dining table**

3

Sheltered aft deck with **al fresco dining area** and **sun mattresses** for an additional lounging area

4

Lounge area with **jacuzzi** on the foredeck

OVERVIEW

The Superyacht “Navilux” was the first Premium class motor sailer built in Croatia (2012). Specifically designed and built for private charters, with outstanding service provided by her 8 attentive, local, English speaking crew members NAVILUX has developed a strong reputation as a leading luxury charter yacht in Croatia.

Boasting 37 meters in length on main deck, MSY Navilux offers accommodation for a maximum of 12 guests in 6 superb cabins (5 double and 1 twin bed cabin). Her impressive exterior provides a great deal of outdoor space for guests, while offering different areas for enjoyment;

- huge sunbathing and lounge area on the top deck,
- lounge area with jacuzzi on the foredeck,
- aft deck furnished with al fresco dining table and chairs, sheltered from the sun; as well, sun mattresses for an additional lounging area.

The interior of MSY Navilux is modern and soothing, complimented with beautifully balanced colors and lines; as the idea was to impose a relaxing yet stylish and elegant atmosphere.

NAVILUX

5

Jacuzzi



Cockpit Table

NAVILUX



Cockpit Sunbeds

NAVILUX



8

Main Salon





Dining Area



Master Cabin A - Natalie Portman

NAVILUX



Master Cabin A - Natalie Portman



NAVILUX



13

Master Cabin B - Grace Kelly

NAVILUX

14

Master Cabin B - Grace Kelly - Bathroom



Twin Cabin C - Marilyn Monroe



Double Cabin D - Ava Gardner

NAVILUX

17

Double Cabin D Bathroom



Double Cabin E - Selma Hayek



Double Cabin F - Audrey Hepburn

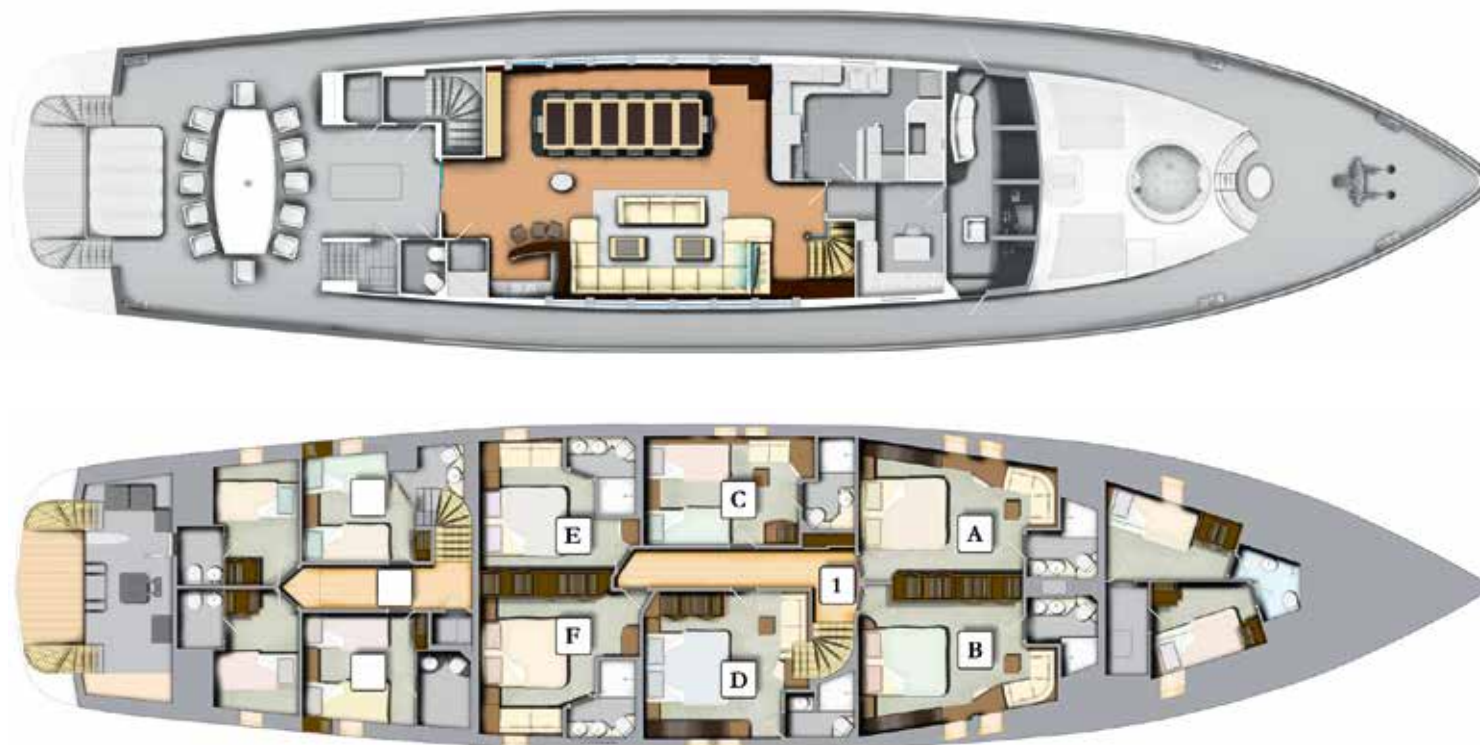

TEHNICAL SPECIFICATIONS

Length: 37.30 m (122' 5")

Beam: 8.30 m (27' 3")

Draft: 3.2 m (10' 6")

Year built: 2012

Interior Designer: Gulet

Flag: Croatia

Hull Construction: Steel

Hull Configuration: Displacement

Engines: 2 x Doosan 265 kW / 360 KS

Generators: 2 x Caterpillar 50kW

Fuel consumption: 80 Litres/Hr

Cruising speed: 10 knots

Number of Cabins: 6

Total Guests: 12

Total Crew: 8

Cabin Configuration: 5 Double, 1 Twin

Number of Beds: 7

Bed Configuration: 5 Queen, 2 Single

Air conditioning

WiFi

Deck Jacuzzi

TENDER & SEA TOYS

6M RIB with 115hp outboard • 2 x Personal watercraft Sea-doo Spark • 2 x Sea Bob
Water skis for adults and children • Wakeboard • 4 x Stand up paddle board • Kayak for 2 people • Tube and donut
Floating mats and foam floating tubes • Snorkeling equipment for adults and children • Fishing lines





NAVILUX

We invite you to discover fascinating Croatia with us!