

# SEAGULL II





# SEAGULL II FOR CHARTER

## *specifications*

**LENGTH** 54.0M / 177'2"

**BEAM** 8.48M / 27'10"

**DRAUGHT** 2.40M / 7'10"

**BUILDER** ULJANIK SHIPYARD

**BUILT** 1952 (2019)

**CRUISING SPEED APPROX** 12.0 KNOTS

**MAXIMUM SPEED APPROX** 14.0 KNOTS

**FUEL CONSUMPTION APPROX** 160 L/HR

## *accommodation*

**CRUISING / OVERNIGHT GUESTS** 12 / 12

**GUEST STATEROOMS** 7 (5 DOUBLE, 2 TWIN)

**NUMBER OF CREW** 9

## *facilities & features*

MASTER PRIVATE APPARTEMENT ON TWO DECKS (SALOON ON MAIN DECK, CABINS ON LOWER DECK)

VIP APPARTEMENT WITH SALOON AND TWO CABINS ON MAIN DECK

GUEST STATEROOMS ON TWO DECKS (SALOONS ON MAIN DECK, CABINS ON LOWER DECK)

JACUZZI ON SUN DECK

WIFI THROUGHOUT

SOFT GYM EQUIPMENT

GOOD SELECTION OF TOYS

UPPER DECK REAR EXTERIOR SITTING AREA



SEAGULL II | 02





































LOWER DECK MASTER STATEROOM 2 DOUBLE





























LOWER DECK GUEST STATEROOM DOUBLE









EASY EXTERIOR ACCESS BETWEEN DECKS

SEAGULL II | 20





SUN DECK AERIAL VIEW



















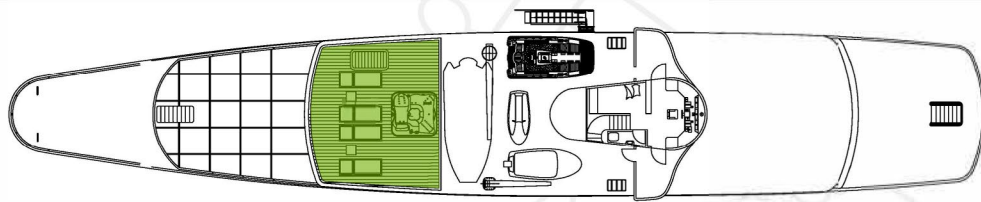
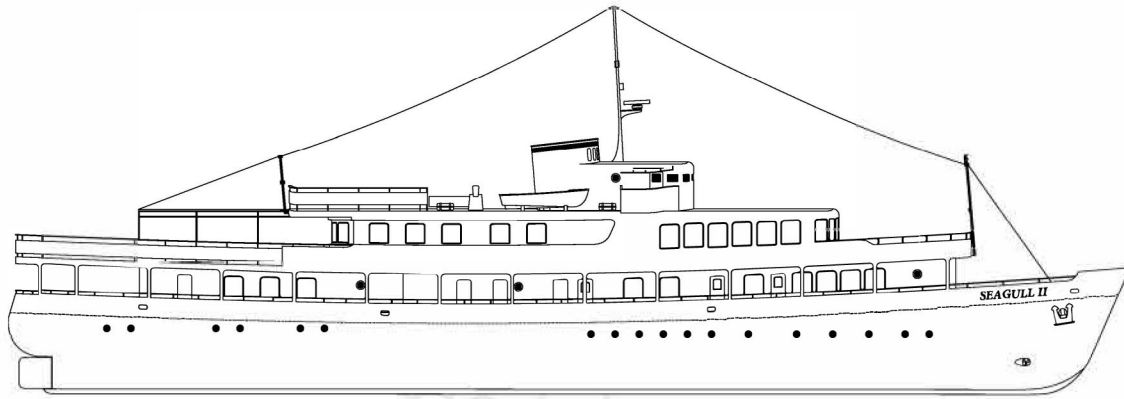

Jacuzzi and sun bathing facilities

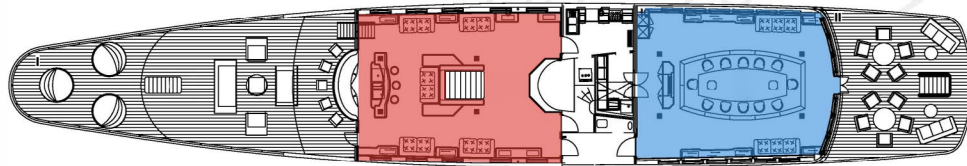

Main Saloon and Gentleman's bar

Formal interior dining room

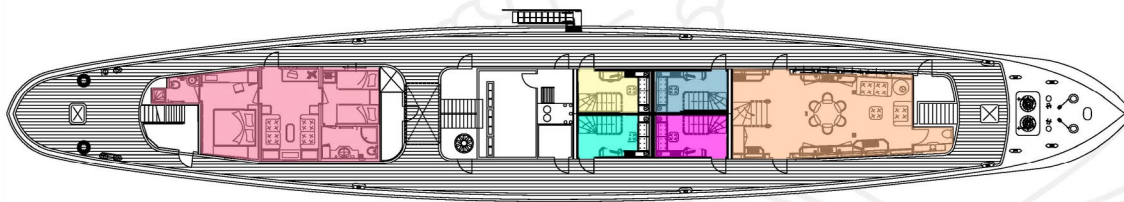

VIP apartment and staterooms (1 double, 1 twin)

Guest cabin 1 saloon

Guest cabin 2 saloon

Guest cabin 3 saloon

Guest cabin 4 saloon

Master apartment private saloon

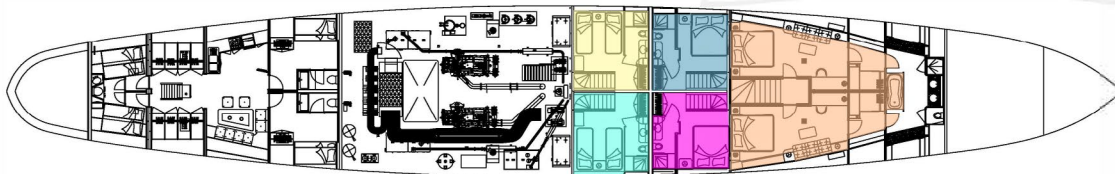

Guest cabin 1 and bathroom

Guest cabin 2 and bathroom

Guest cabin 3 and bathroom

Guest cabin 4 and bathroom (double)

Master staterooms and bathroom (2 double)





Disclaimer: All the particulars of this charter vessel are correct at the time of writing and given in good faith but cannot be guaranteed. Inventory and toys lists are subject to change at short notice and do not form part of a formal charter agreement. Any interested party should confirm such details of concern to them by inspection or by requesting verification. This vessel is offered subject to price change, prior sale or withdrawal without notice.